

# MECHANICAL HANDS-FREE ROLL TOWEL DISPENSER

## Installation Overview:

Choose a location that provides open area forward of the unit to allow proper opening. Location should allow the cover to be opened for installation, maintenance, and usage.

## Installation Steps:

- 1: Select a location that allows the unit to open completely, and allows the paper area to be free of obstructions.
- 2: Dispensers should be installed on the wall at a minimum height of 48" above the floor and no less than 12" above a surface.
- 3: Attach unit to the wall surface using the hardware provided. Use a level to insure proper mounting. Use the provided anchors when necessary.

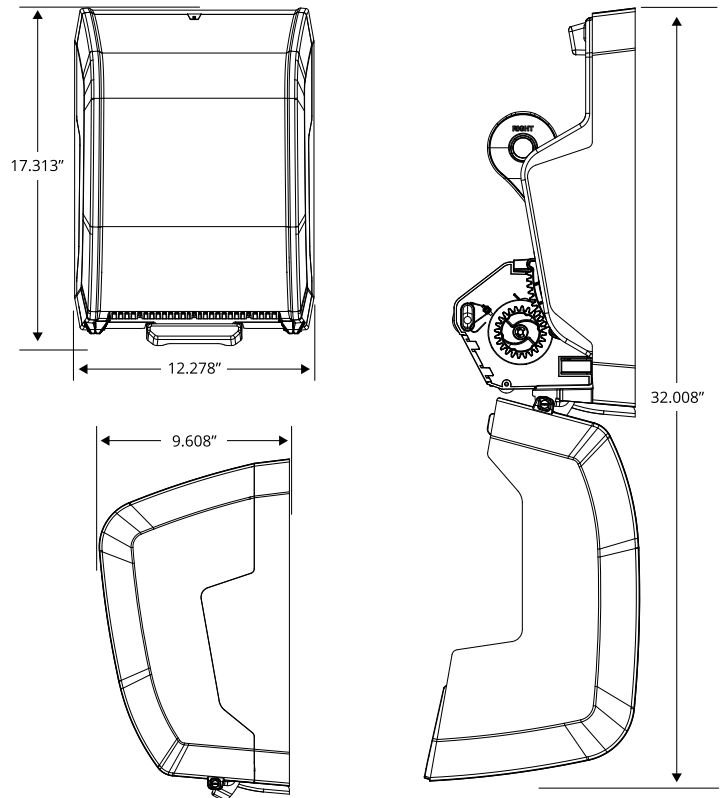

## Product Specifications:

This Mechanical Auto-Cut Roll Towel Dispenser is designed to accept Solaris Paper LoCor Roll Towel.

## Weight:

6.00 lbs.

## Overall Dimensions:

Width: 12.28"

Height: 17.31"

Depth: 9.61"

PN: 8204007



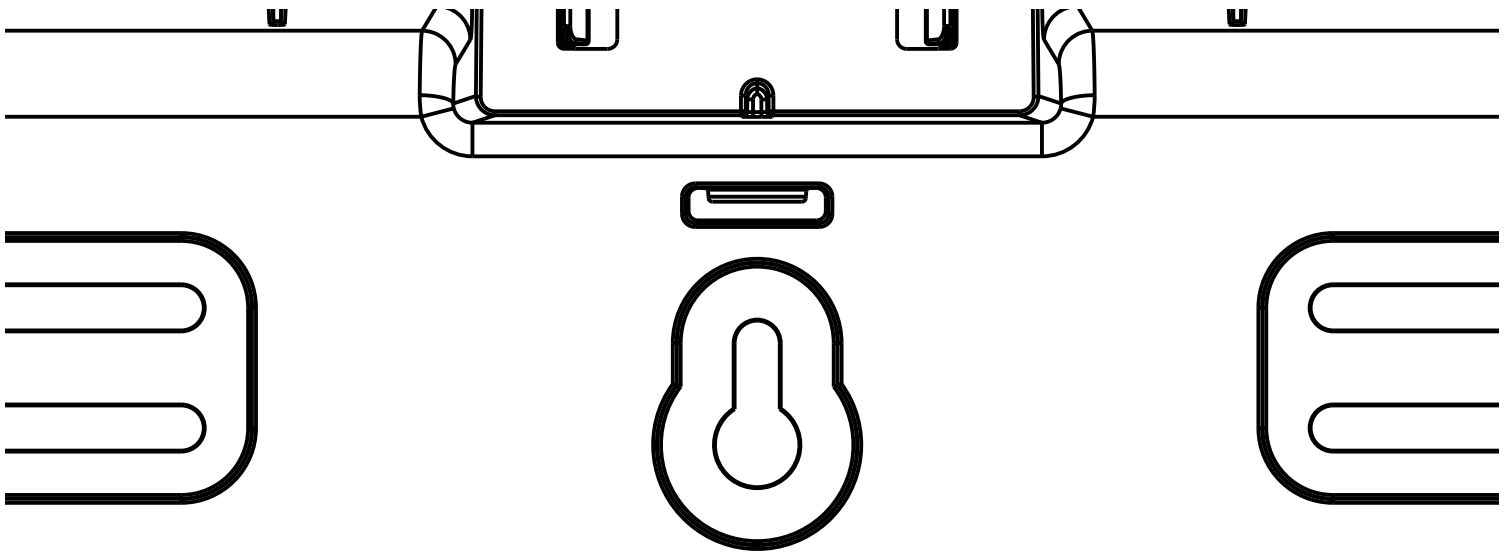

## MOUNTING TEMPLATE

**DISCLAIMER:** If printing this document, please ensure your printer is set to 100% scale. We are not responsible for damage to surfaces.

